

56 Gloucester Mews, London, W2

Development Summary

CONTENTS

Summary	3
Location	5
Construction	6
Floor Plans	7

Summary

56 Gloucester Mews



We acquired this property for a large property company and project managed the complete refurbishment and re-building of this residential property in one of Paddington's most popular locations. We successfully obtained planning permission to refurbish and make substantial alterations to this existing residential mews property. Our proposal included for alterations to the external elevation, relocating the front entrance door and replacing the existing garage door for timber sash windows.

The internal fabric of the property and front elevation have been completely refurbished and a full automation system was installed throughout.

By altering the front elevation we were able to improve the usability of the property, whilst still retaining the charm and appearance of the mews as a whole.

The existing garage was not suitable for modern cars and therefore converted into usable habitable living space.

The comprehensive programme of works took approximately five months to complete and the Property has now been let out achieving one of the highest rental figures within the mews.

Kessy Property Consultants was responsible for delivering the project on budget and on time to a turn key finish for the client.

Summary

56 Gloucester Mews





56 Gloucester Mews

Construction Photos

56 Gloucester Mews



Ground Floor

56 Gloucester Mews

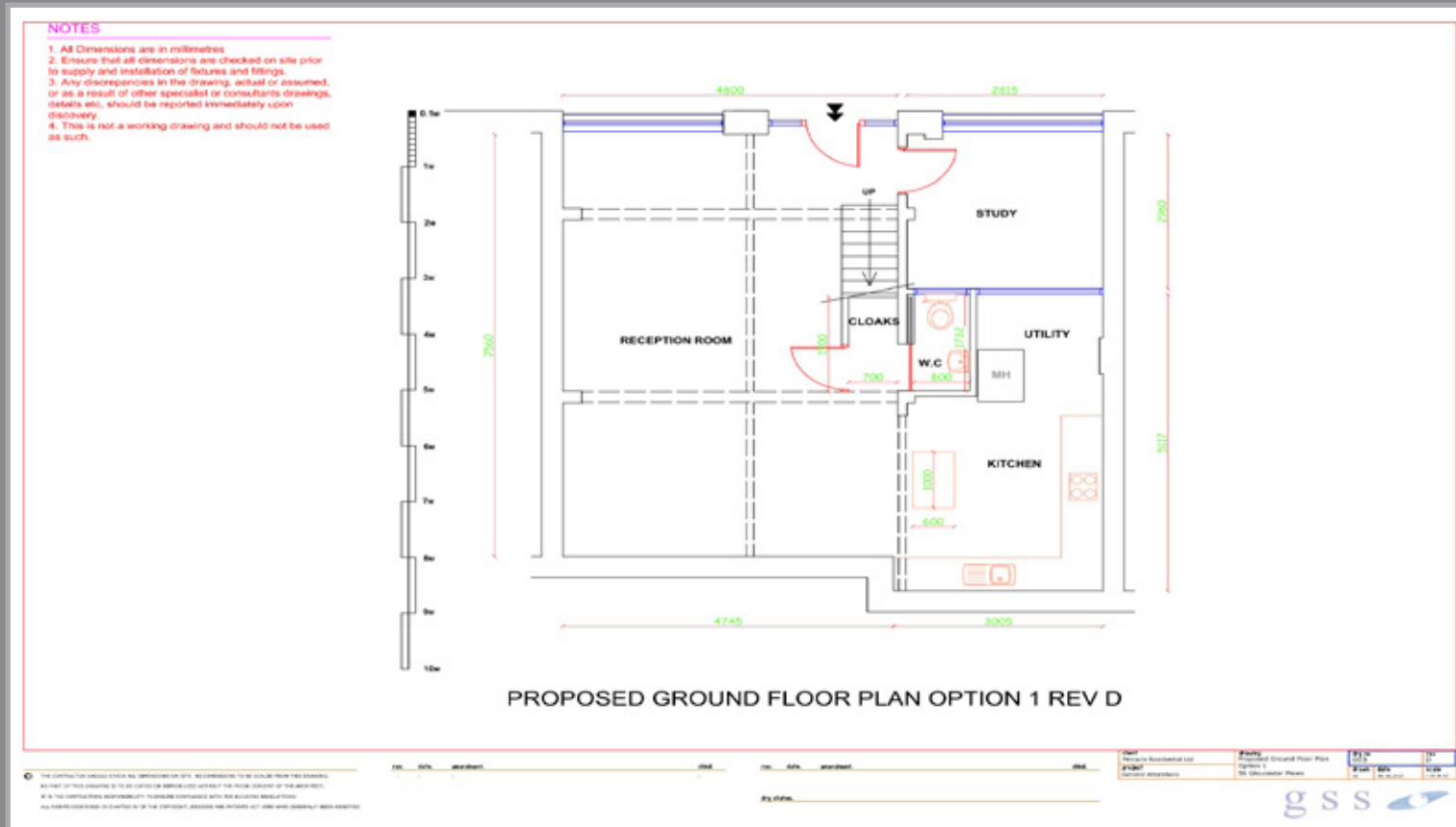

First Floor

56 Gloucester Mews

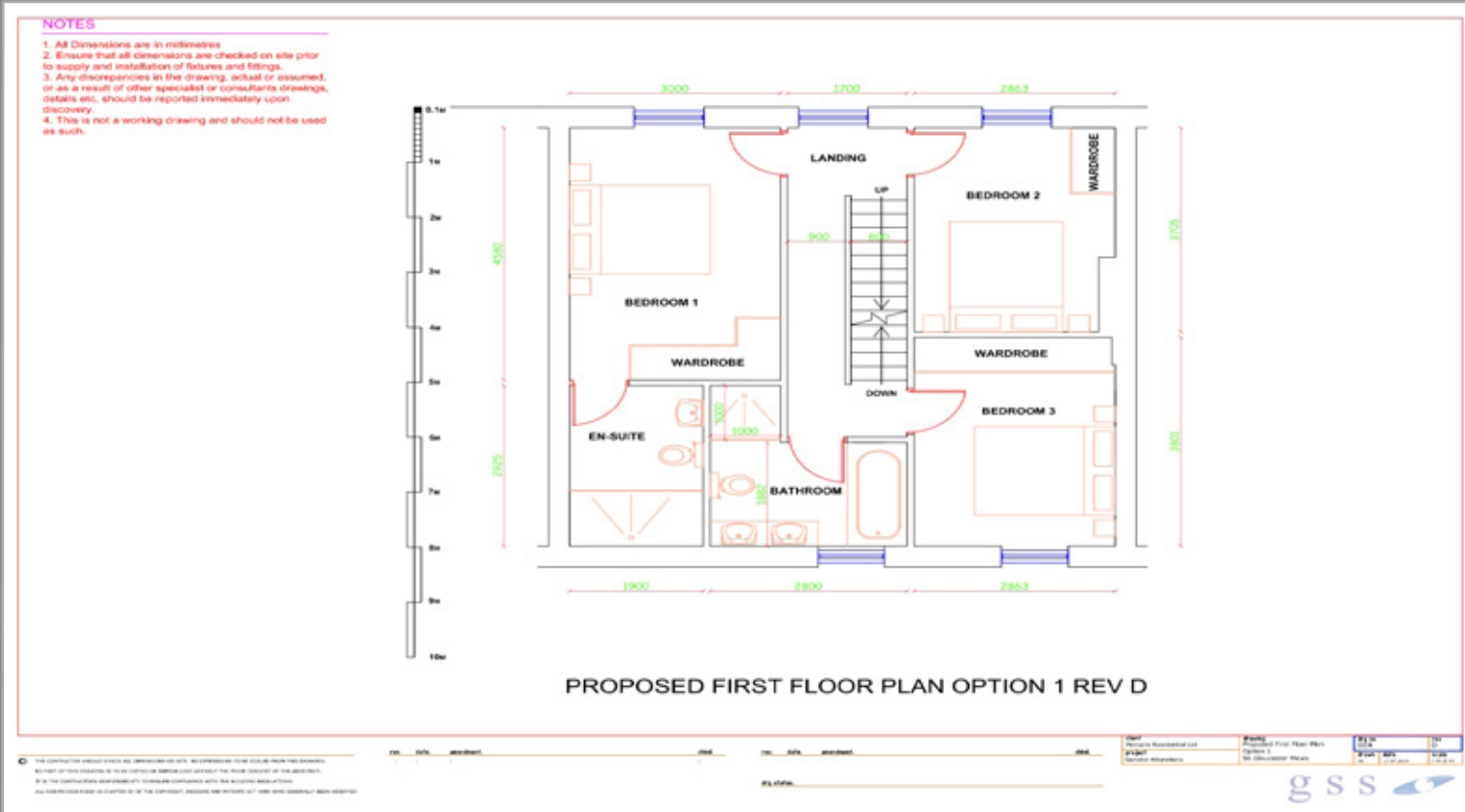

Front Elevation

56 Gloucester Mews



PROPOSED FRONT ELEVATION



Kessy Property Consultants

redefining development | refining investment

Kessy Property Consultants
10 Bullhead Rd,
Borehamwood, Herts
WD6 1HS
T: 0208 953 2731
M:07887 70 60 50